

GW304-LP Low Profile Threaded Insert

Stainless steel 304 · Low profile · Round · Open end
M4 - M12

Features

- Designed to provide load bearing threads in thin sheet materials
- Low profile head allows near flush fit to application

Material

- Stainless steel 304

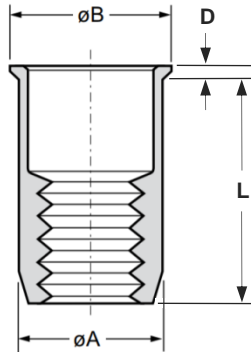

Before Placement

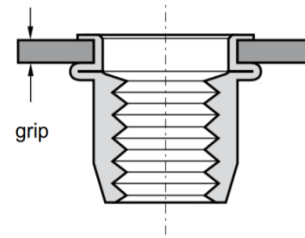

After Placement

Part No.	Thread Size	Grip Range		Hole Size	øA	øB	D	L
		min.	max.					
GW304-LPM4-0520	M4	0.5	2.0	6.0	6.0	6.5	0.5	11.0
GW304-LPM5-0530	M5	0.5	3.0	7.0	7.0	7.5	0.5	12.0
GW304-LPM5-3050		3.0	5.0					15.0
GW304-LPM6-0530	M6	0.5	3.0	9.0	9.0	9.5	0.5	14.5
GW304-LPM6-3050		3.0	5.0					16.5
GW304-LPM8-0530	M8	0.5	3.0	11.0	11.0	11.5	0.5	16.0
GW304-LPM8-3055		3.0	5.5					18.5
GW304-LPM10-0835	M10	0.8	3.5	13.0	13.0	13.5	0.5	21.0
GW304-LPM10-3560		3.5	6.0					23.5
GW304-LPM12-1040	M12	1.0	4.0	16.0	16.0	16.8	0.7	26.0

Thread Size	Max. torque	Pull-out	Torque-to-turn	Shear strength
	Nm max.	Kn	Nm	kN
M4	~7.1	> ~11.0	~2.6	~3.5
M5	> ~16.0	> ~14.5	~3.0	~4.8
M6	> ~22.0	> ~27.0	~6.8	~7.3
M8	> ~70.0	> ~40.0	~9.0	~9.0
M10	> ~70.0	> ~43.0	~13.0	~8.4
M12	> ~130.0	> ~70.0	> ~70.0	~14.6